

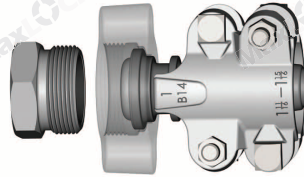

**MaxLOCK®**  
**GROUND JOINT**



**Features:**

- Positive metal-to-polymer seal
- Leakproof seal forms when the metal head of the stem makes contact with the patented polymer seat in the spud
- Non-metallic polymer seat resists most chemicals found in manufacturing facilities
- Recommended for steam service up to **450°F (232°C)**
- Easy to seal
- Use with Maxlock® clamps

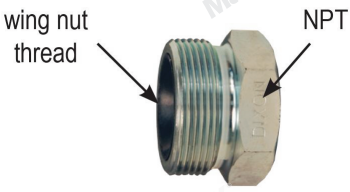
MAXLOCK GROUND JOINT FEMALE SPUDS (MG-FS)	SIZE	OPTIONAL QTY
 <p>wing nut thread</p> <p>NPT</p>	1/4"	100
	3/8"	100
	1/2"	100
	1/2" x 3/4"	50
	3/4"	50
	1"	50
	1 1/4"	25
	1 1/2"	25
	2"	10
	2 1/2"	5
3"	5	
4"	5	
6"	2	

**PART NUMBER**



MODEL	PART NO.	MATERIAL	COUPLING SIZE
<b>MG</b> Maxlock Ground Joint	JS	<b>PS</b>	<b>8</b> = 1/4"
	JC	Plated Steel	<b>10</b> = 3/8"
	WN	<b>SS</b>	<b>15</b> = 1/2"
	FS	Stainless Steel 316	<b>20</b> = 3/4"
	MP		<b>25</b> = 1"
	DS	<b>BR</b>	<b>32</b> = 1-1/4"
	FA	Brass	<b>40</b> = 1-1/2"
	MA		<b>50</b> = 2"
	MS		<b>65</b> = 2-1/2"
			<b>100</b> = 4"
			<b>150</b> = 6"