

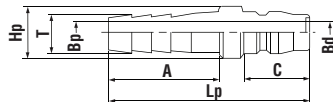

MaxLOCK® QRC 1 SERIES

Interchangeable with Nitto Hi Cupla, Dixon NK Series.

MAXLOCK® NIPPLE (HOSE END)



Size	Body Material • Mass (g)			Dimensions (mm)						
	Steel	Brass	Stainless Steel	Lp	øHp	A	C	øT	øBp	øBd
¼	24	-	-	54	16	27	20	7.2	4.5	7.5
¼	28	30	26	57	16	30	20	9	5	7.5
⅜	31	34	27	61	16	34	20	11.3	7.5	7.5
½	53	58	47	63	20	36	20	15	7.5	7.5
½	66	72	67	66	22	36	23	15	9	13
¾	121	132	129	77	30	45	23	21	13	13
1	152	167	150	85	34	54	23	27	20	13

MAXLOCK® COUPLER (HOSE END)

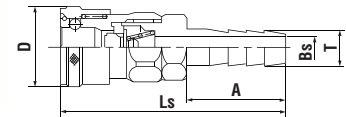

Size	Body Material • Mass (g)			Dimensions (mm)					
	Steel	Brass	Stainless Steel	Ls	øD	A	T	øBs	
¼	99	-	-	69.5	26.5	27	7.2	4.5	
¼	103	107	100	72.5	26.5*	30	9	5	
⅜	106	111	101	76.5	26.5*	34	11.3	7.5	
½	118	124	118	78.5	26.5*	36	15	9	
½	220	240	218	83	35	36	15	9	
¾	251	273	242	92	35	45	21	13	
1	273	299	272	102	35	55	27	16	

MAXLOCK® NIPPLE (MALE THREAD)

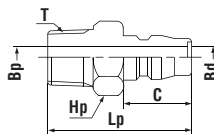

Size	Body Material • Mass (g)			Dimensions (mm)					
	Steel	Brass	Stainless Steel	Lp	Hp (WAF)	C	T	øBp	øBd
RC ⅛	22	24	-	37	Hex.14	20	R ⅛	4	7.5
RC ¼	25	28	27	41	Hex.14	20	R ¼	7.5	7.5
RC ⅜	43	48	40	42	Hex.19***	20	R ⅜	7.5	7.5
RC ½	59	66	62	46	Hex.22	20	R ½	12	7.5
RC ½	69	77	70	50	Hex.22	23	R ½	13	13
RC ¾	116	126	115	55	Hex.32	23	R ¾	19	13
RC 1	180	196	180	63	Hex.35	23	R 1	22	13

MAXLOCK® COUPLER (MALE THREAD)

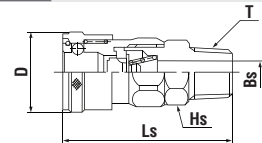

Size	Body Material • Mass (g)			Dimensions (mm)					
	Steel	Brass	Stainless Steel	Ls	øD	Hp (WAF)	T	øBs	
Rc ⅛	98	-	-	52.5	26.5	Hex.19	R ⅛	5	
Rc ¼	101	104	96	55.5	26.5*	Hex.19	R ¼	7	
Rc ⅜	108	119	105	56.5	26.5*	Hex.19	R ⅜	8	
Rc ½	131	136	120	59.5	26.5*	Hex.23**	R ½	9	
Rc ½	213	232	207	63	35	Hex.29	R ½	13	
Rc ¾	260	283	241	67	35	Hex.32	R ¾	16	
Rc 1	288	317	303	72	35	Hex.36	R 1	16	

MAXLOCK® NIPPLE (FEMALE THREAD)

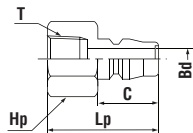

Size	Body Material • Mass (g)			Dimensions (mm)					
	Steel	Brass	Stainless Steel	Lp	Hp (WAF)	C	T	øBd	
R ¼	28	30	30	36	Hex.17	20	RC ¼	7.5	
R ⅜	39	41	41	37	Hex.21	20	RC ⅜	7.5	
R ½	70	77	69	38	Hex.29	20	RC ½	7.5	
R ½	82	89	81	41	Hex.29	23	RC ½	13	
R ¾	116	126	118	45	Hex.35	23	RC ¾	13	
R 1	190	202	192	54	Hex.41	23	RC 1	13	

MAXLOCK® COUPLER (FEMALE THREAD)

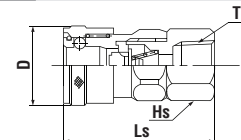

Size	Body Material • Mass (g)			Dimensions (mm)				
	Steel	Brass	Stainless Steel	Ls	øD	Hp (WAF)	T	
R ¼	95	103	98	49.5	26.5*	Hex.19	RC ¼	
R ⅜	103	105	99	50.5	26.5*	Hex.21	RC ⅜	
R ½	139	149	138	52.5	26.5*	Hex.29	RC ½	
R ½	216	235	216	57	35	Hex.29	RC ½	
R ¾	260	283	258	61	35	Hex.35	RC ¾	
R 1	324	353	317	68	35	Hex.41	RC 1	

MAXLOCK® NIPPLE (FEMALE PARELLER THREAD)

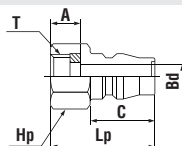

Application (Hose)	Body Material • Mass (g)			Dimensions (mm)					
	Steel	Brass	Stainless Steel	Lp	Hp (WAF)	A	C	T	øBd
G ¼	23	-	-	32	Hex.17	9	20	G ¼	7.5

Above pictures are plugs and sockets of steel 20, 30 and 40 models.
 * D = 25.4 for brass and stainless steel models
 ** Hs = Hex. 22 for brass and stainless steel models
 *** Hp = Hex. 17 for brass and stainless steel models



MaxLOCK®

PART NUMBER



SERIES	MATERIAL	COUPLING TYPE	COUPLING SIZE	END FITTING SIZE	END FITTING TYPE	SEALS	OPTIONS
QRC 1	SP Steel Plated	C Coupler	8 = 1/4"	8 = 1/4"	F Female NPT	Std. seal is Buna	SL Sleeve Lock
	SS 316 Stainless Steel	N Nipple	10 = 3/8"	10 = 3/8"	M Male NPT	V Viton	
	SH High Pressure Stainless Steel		15 = 1/2"	15 = 1/2"	H Hose End	E Ethylene Propylene Rubber	
			20 = 3/4"	20 = 3/4"		M MIL-H-5606	
			25 = 1"	25 = 1"			

- * For sizes up to 1" NPTF threads in steel.
For sizes up to 1" NPSF threads in stainless steel.
For sizes up over 1" NPT threads.
- ** Available on 1/8" coupling sizes only.
- + Available for 1/4" stainless steel units only.

ACCESSORIES

	COUPLER DUST PLUG	NIPPLE DUST CAP
SIZE	1 Style	1 Style
1/8"	N/A	N/A
1/4"	1-SDP-4	1-NDC-4
3/8"	1-SDP-6	1-NDC-6
1/2"	1-SDP-8	1-NDC-8
3/4"	1-SDP-12	1-NDC-12
1"	1-SDP-16	1-NDC-16

* Upon request.

WORKING PRESSURE

SIZE	PRESSURE	
	PSI	BAR
1/4"	300	21
3/8", 1/2", 3/4"	150	11
1", 1"-1/4"	75	5
1"-1/2", 2"	0	0

* Based on Stainless Steel material.